

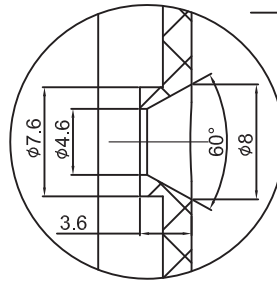

Structured Cable Products™
Quality Installations Deserve Quality Products

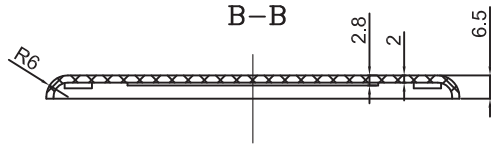

H
2:1

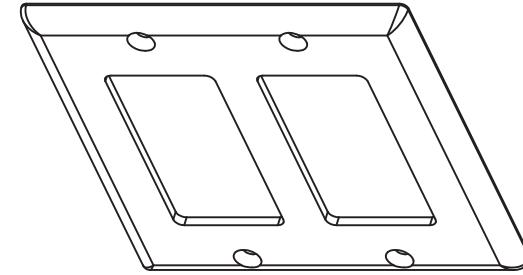

A-A

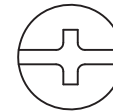
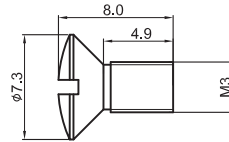
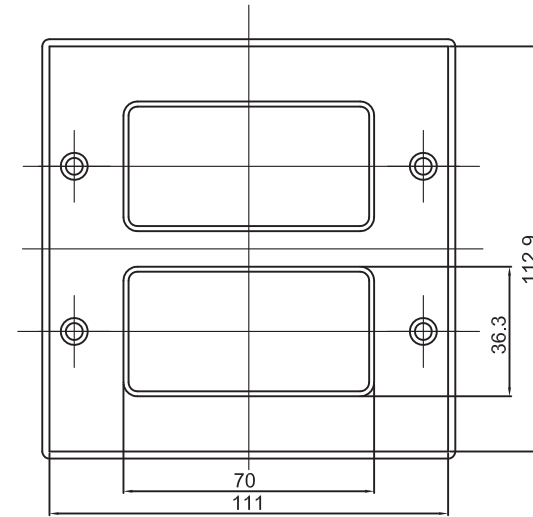
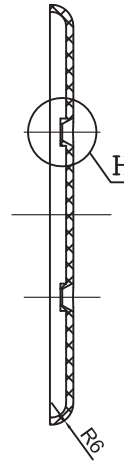
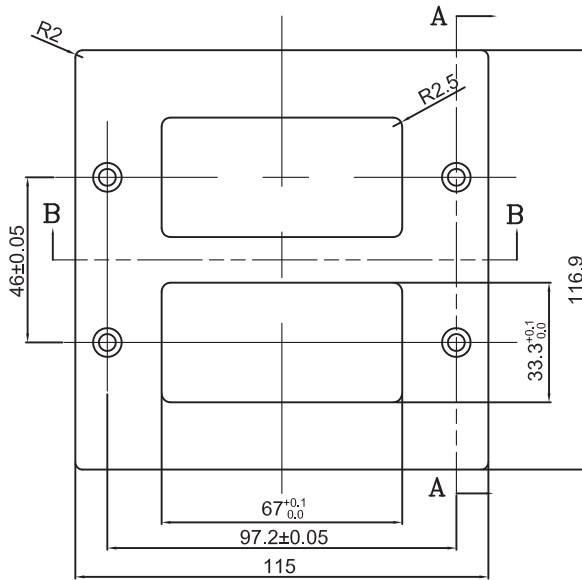

Colors Available: Light Almond & White

MATERIAL:

Plastic housing: ABS high-impact UL94V-0 thermoplastic
Operating Temperature Range: -10°C to 60°C
Storage Temperature Range: -40°C to 68°C
Humidity: 10%~90%RH

ENCLOSURE:

1: K4-6x8mm (M3x5mm) screws x 4
plating nickel on surface
screw head color matches wall plate color

Scale	1:2	All Copy Rights Reserved				
3rd Angle Projection		DOUBLE GANG - Decorator Style Face Plate				
Unit	mm	SCP P/N				
Date	2015-09-16	200D-2G-XX				
Tolerance						Drawn by
~20	~50	~150	150~	ANGLE		Checked by
±0.2	±0.4	±0.5	±1.5	±2°	FHL	Santiago